

# Finding gas leaks is only a first step to our goal.

We assist you to manage leaks until completion of repair work.

Photographs of gas leak locations along with measurement values from the device are sent to a sever. No impropriety actions are possible as the photos and the gas leak data are sent as one set of information. (Patent Pending) Following events such as repair works and post-repair gas leak checks are also recorded in the database for proper management. Reduction of methane emission to the environment is our ultimate goal by LaseMethane Smart.



## LaseMethane SMART

Compact and Portable Methane Gas Detector

### Remote detection

**Searching range: 30m** – keeps operators away from harm.  
**Green guide laser light** – gives clear visibility of the searching point even under bright sunshine.

### Quick response

**0.1sec response time** – allows swift searching gas leaks.

### Persuasive evidence

**Laser co-axis digital camera** – records photos of inspection points.  
**Storing data on a cloud server** – secures measurement data and the photos via android or IOS devices.

### User friendly

**Point and shoot technology** – requires little or no training to use.  
**Compact and lightweight** – enables mobile gas searching tasks with ease. The weight is only 500g including batteries.  
**Wide LCD display with touch panel** – enables inspection work under Sunshine.  
**Ni-MH rechargeable battery** – can be now used with the device.

### Reliability

**No moving parts and no gas suction in principle** – require little maintenance. LaseMethane Smart inherits the proven LaseMethane technology.  
**Self-check and automatic calibration on start-up** – ensures accurate and reliable gas leak detection.

### Safety

**Certified for explosion protection in IECEx and ATEX**

**Model No.**  
**LM2B03E-SBA**  
**LM2B03E-SNA**

## Features of devices with Bluetooth (Version : LM2B03E-SBA)

Allow users to manage the Entire Maintenance Process.

Gas Leak  
Inspection

Repair  
&  
Check

Periodic  
Inspection

Find Gas Leak

Create Reliable Inspection Records

Store Evidence on Cloud Server



New Product & Service



## Main Specifications

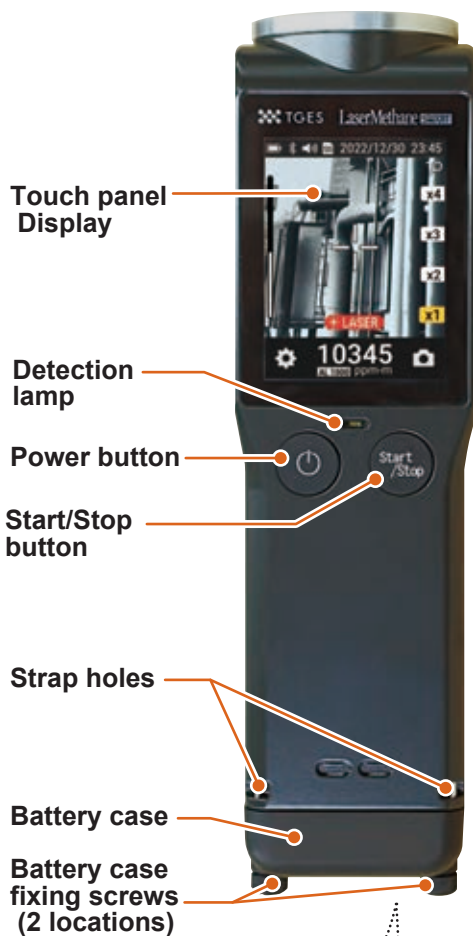

### Labels



ITEMS		SPECIFICATIONS
Model	LM2B3E-SBA	Bluetooth enables data storage via communication with the cloud
	LM2B3E-SNA	No Bluetooth
Target gas		Methane(CH4) Methane containing gases (e.g. natural gas)
Unit		ppm•m
Detection limits		1~50,000ppm•m
Detection accuracy		± 10% at 100,1000ppm•m (distance 2m)
Detection response time		0.1 second
Detection distance		0~30m
Power supply		Designation batteries (AA Ni-MH Battery) Panasonic Corporation : eneloop, eneloop pro, eneloop lite*
Continuous operating time		Full operation (@ 25°C) : 2.5 hours Battery : Panasonic eneloop used (Panasonic "eneloop Pro" is 3.5 hours)
Laser safety		IEC60825-1:2014 Guide laser beam (green) Output level : 5mW (Class 3R) Below Measuring laser beam Output level : 10mW (Class1) Below • Do not look into the laser beam.
Explosion proof standard		Ex II 3 (1) G EX ic [op is Ga] II A T4 Gc ATEX : EN60079-0, -11, -28 IECEx : IEC60079-0, -11, -28
Protection class		Dust and drip proof construction (IP54 equivalent)
Environmental conditions		Operating temperature range : -17°C ~ +50°C Operating humidity range : 30-90% (No condensation)
Dimensions and weight		Dimensions : 55mm(W)×200mm(D)×53mm(H) Weight : 500g When 4 batteries (eneloop) are installed
Measurement data storage		Recorded on an installed microSD card (capacity 16 Gb).

\* Batteries are not included with this device. Four batteries are required and must be supplied by the user.